

PACKAGE	Carton 244 mm(W) × 620 mm(D) × 748 mm(H)
ACCESSORIES	Installation Kit
OPERATION CONDITIONS	Voltage Range: Rated Voltage ±6%, Ambient Temp: 5-40°C Water Supply Temp.: 5-35°C, Water Supply Press: 0.05-0.78MPa(0.5-7.8bar)

*We reserve the right to make changes in specifications and design without prior notice.

1. Install the product properly in accordance with the instructions on location, electrical connections stated in the instruction manual provided. Allow 10mm extra space at the installation site to meet any installation requirements(additional spacing is also required for proper air flow).
2. The ice production depends on the ambient and water temperatures. Refer to the instruction manual.
3. Product Code : L016-C401 (For CONTINENTAL PLUG)
L016-C402 (For UK PLUG)

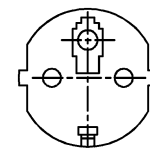

PLUG SHAPE (EU CONTINENTAL)

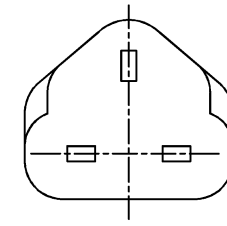

PLUG SHAPE (UK)

ITEM	Hoshizaki Shuttle Ice Dispenser
MODEL	DSM-12DE
POWER SUPPLY	1 PHASE 220-240V 50Hz Capacity: 0.49kVA (2.1A)
AMPERAGE	Rated: 1.6A(AT. 32°C, WT. 21°C) Starting: 5.1kVA
ELECTRICAL CONSUMPTION	200W(AT. 32°C, WT. 21°C) (Power factor: 51%)
ICE PRODUCTION PER 24h	Approx. 13kg(AT. 10°C, WT. 10°C) Approx. 11kg(AT. 21°C, WT. 15°C) Approx. 9kg(AT. 32°C, WT. 21°C)
WATER CONSUMPTION PER 24h	Approx. 0.108m ³ (AT. 10°C, WT. 10°C) Approx. 0.088m ³ (AT. 21°C, WT. 15°C) Approx. 0.081m ³ (AT. 32°C, WT. 21°C)
SHAPE OF ICE	Shuttle
FREEZE CYCLE TIME	Approx. 12min(AT. 21°C, WT. 15°C)
ICE PRODUCTION PER CYCLE	Approx. 0.085kg / 27pcs.(AT. 21°C, WT. 15°C)
STORAGE CAPACITY	Approx. 3kg
ICE DISPENSING RATE	Approx. 700g / min
DIMENSIONS	180 mm(W) × 527 mm(D) × 695 mm(H)
EXTERIOR	Acrylic Baked Steel (Cabinet), ABS Molding (Front Panel)
INSULATION	Polyurethane Foam
INSULATION FOAM BLOWING AGENT	HFO-1233zd(E)
CONNECTIONS -ELECTRIC	Y-Type Connection
CONNECTIONS -WATER SUPPLY	Inlet G3/4 (Connected at rear side)
CONNECTIONS- DRAIN	Outlet R1/2 (Connected at rear side)
ICE MAKING SYSTEM	Mandrel type, Water agitated by plate
HARVESTING SYSTEM	Hot Gas Defrost, Water Pan tilted by motor
ICE DISPENSING SYSTEM	Auger Operated by Push Switch
COMPRESSOR	Hermetic
CONDENSER	Air-cooled, Fin and Tube type
HEAT REJECTION	300W(258 kcal/h)(AT. 32°C, WT. 21°C)
EVAPORATOR	Tin-plated copper tube on sheet with copper mandrel
REFRIGERANT CONTROL	Capillary Tube
REFRIGERANT CHARGE	R134a/80g
ICE MAKING CONTROL	Ice thickness measurement
HARVESTING CONTROL	Thermistor on Evaporator Outlet
ICE STORAGE CONTROL	Microswitch
WATER SUPPLY CONTROL	Water Pan's movement
ICE MAKING WATER CONTROL	Overflow
ELECTRICAL PROTECTION	Class I Appliance, 5A Fuse
P.C. BOARD CIRCUIT PROTECTION	High Voltage Cut-out(Internal)
COMPRESSOR PROTECTION	Auto-reset Overload Protector(Internal)
GEAR MOTOR PROTECTION	Auto-reset Thermal Protector
WEIGHT	26kg (Gross 28kg)

HOSHIZAKI SHUTTLE ICE DISPENSER DSM-12DE

APPROVED KUROYANAGI	CHECKED MORIMOTO	DESIGNED SUGITA	DRAWN OHASHI	SCALE 1/10	TRIGONOMETRY
NISHIO	HANAI	2018.07.19	DATE 2015.03.09	DRAWING NO. D15848	SYMBOL 2
APPROVED	DESIGNED	SYMBOL	DATE		